



# SAMRUDDHI INDUSTRIES

Industries Crimping Tools



+91 96571 58884 | +91 97668 20338



[www.samruddhiindustries.co.in](http://www.samruddhiindustries.co.in)





## CERTIFICATE

This is to Certify that the Management System of

### SAMRUDDHI INDUSTRIES

WADGAONSHERI, SERVE NO.53 58, SAINATH NAGAR, WADGAON SHERI,  
SAINATHNAGAR, PUNE- 411014, MAHARASHTRA, INDIA.

has been found to conform to the Quality Management System standard:

### ISO 9001:2015

This certificate is valid for the following scope of operations:

**MANUFACTURING OF CRIMPING MACHINE, APPLICATOR  
AND SUPPLY OF ALL TYPES OF MACHINING COMPONENTS.**

IAF Code: 17                      NACE Code: 25.50

**:: Certificate No :: IN121323A**

Date of initial registration	Date of this Certificate	Surv. audit on or before / Certificate expiry	Recertification Due
17 December 2022	17 December 2022	16 December 2023	16 December 2025

This Certificate remains valid subject to satisfactory surveillance audits.



  
 Director



For verification and updated information concerning this present certificate visit to [www.lmscertifications.com](http://www.lmscertifications.com)  
This Certificate is the property of LMS Certifications Private Limited and shall be returned immediately when demanded.





LMS Certifications Private Limited  
1, Anandghem, Opp. Kulkarni Park, Spout Gate,  
Hindi Nagar, Lucknow - 226019, U.P. (INDIA).  
Phone : +91-9584245164  
Mail : [www.lmscertifications.com](mailto:www.lmscertifications.com)  
E-mail : [info@lmscertifications.com](mailto:info@lmscertifications.com)

LMS/FH/01/04/REV06

# Manufactures

- Side Feed Applicators
- End Feed Applicators
- Fuse Terminal Applicators
- Joint Terminal Applicators
- Flag Terminal Applicators
- Total Spares Part And Tooling Of Applicator



# Side Feed Mini Applicator

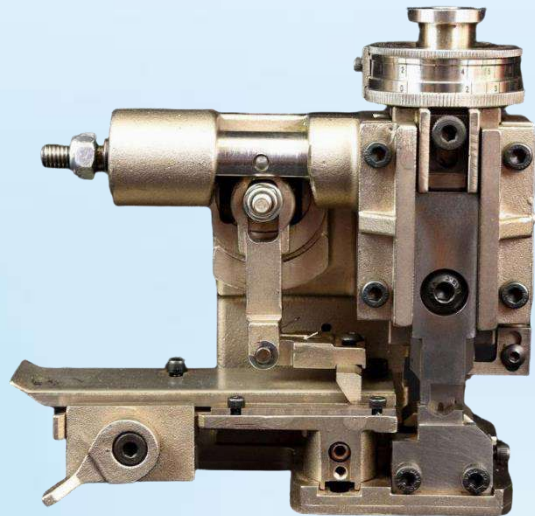

## Four Position Head (Optional)

Allows for 4 crimp height positions. Crimp Specs will be provided by Samruddhi engineering.

- Mechanical Side feed.
- Feeding system for linked terminals on a reel to be unrolled left to right.
- Non-resettable 7-digit cycle counter.
- Can be fitted to any crimping press having a crimping height of 135.8mm (+/-) 0.02mm.
- Can be used in both manual and automatic configuration.
- Easy replacement of crimpers and anvils.

Description	Evolution Left Side Feed Mini Applicator
Crimping Height	135.8mm , 5.346"
Stroke	40/30mm , 1.575/1.18"
Terminal Pitch	< 28mm , < 1.10"
Terminal Thickness	< 1.00mm
Wire Section	Max 6 mm <sup>2</sup>
Feeding System	Mechanical
Weight	3 Kg , 6.6 lb
Dimensions	W 144 x H 145.5 x D 190 (mm) W 5.66" x H 5.72" x D 4.13" (inches)
Continuous Regulating Head	0.01mm resolution, 0.00039" 2.7mm range, 0.106"

# End Feed Mini Applicator

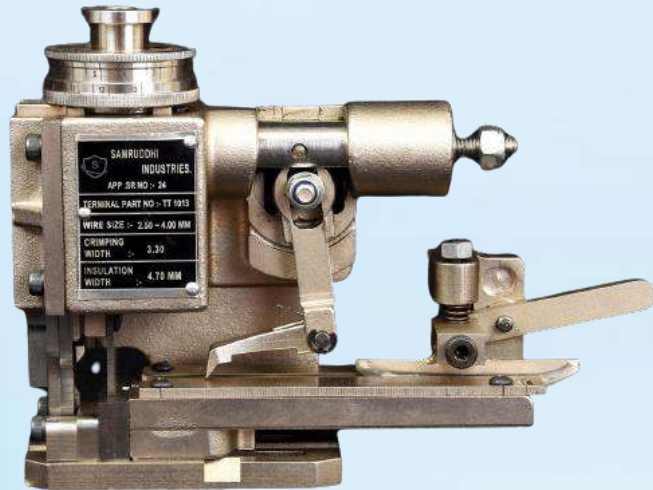

Description	Evolution End Side Feed Mini Applicator
Crimping Height	135.8mm , 5.346"
Stroke	40/30mm , 1.575/1.18"
Terminal Pitch	< 28mm , < 1.10"
Terminal Thickness	< 1.00mm
Wire Section	Max 6 mm <sup>2</sup>
Feeding System	Mechanical
Weight	3 Kg , 6.6 lb
Dimensions	W 144 x H 145.5 x D 190 (mm) W 5.66" x H 5.72" x D 4.13" (inches)
Continuous Regulating Head	0.01mm resolution, 0.00039" 2.7mm range, 0.106"

## Four Position Head (Optional)

Allows for 4 crimp height positions. Crimp Specs will be provided by Samruddhi engineering.

- Mechanical End feed.
- Feeding system for linked terminals on a reel to be unrolled left to right.
- Non-resettable 7-digit cycle counter.
- Can be fitted to any crimping press having a crimping height of 135.8mm (+/-) 0.02mm.
- Can be used in both manual and automatic configuration.
- Easy replacement of crimpers and anvils.

# Splicing / Joint Mini Applicator



Description	Evolution End Side Feed Mini Applicator
Crimping Height	135.8mm , 5.346"
Stroke	40/30mm , 1.575/1.18"
Terminal Pitch	< 28mm , < 1.10"
Terminal Thickness	< 0.6mm , < 0.023"
Wire Section	Max 8 mm <sup>2</sup>
Feeding System	Mechanical
Weight	3.5 Kg
Dimensions	W 144 x H 145.5 x D 190 (mm) W 5.66" x H 5.72" x D 4.13" (inches)
Continuous Regulating Head	0.01mm resolution, 0.00039" 2.7mm range, 0.106"

## Four Position Head (Optional)

Allows for 4 crimp height positions. Crimp Specs will be provided by Samruddhi engineering.

- Mechanical End feed.
- Feeding system for linked terminals on a reel to be unrolled left to right.
- Non-resettable 7-digit cycle counter.
- Can be fitted to any crimping press having a crimping height of 135.8mm (+/-) 0.02mm.
- Can be used in both manual and automatic configuration.
- Easy replacement of crimpers and anvils.

# Flag Terminal Mini Applicator

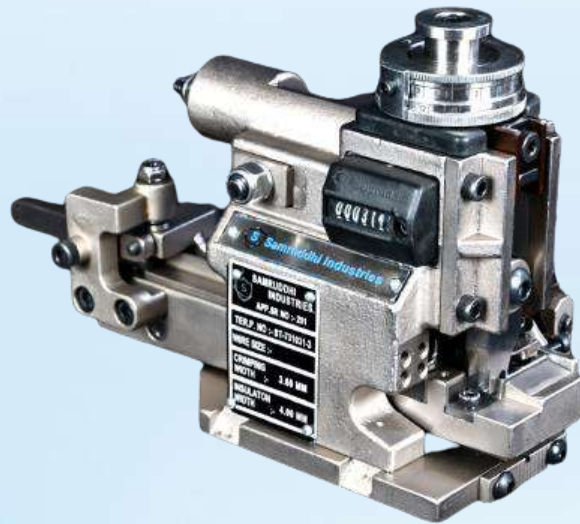

## Four Position Head (Optional)

Allows for 4 crimp height positions. Crimp Specs will be provided by Samruddhi engineering.

- Mechanical End feed.
- Feeding system for linked terminals on a reel to be unrolled left to right.
- Non-resettable 7-digit cycle counter.

Description	Evolution End Feed Flag Terminal Mini Applicator
Crimping Height	135.8mm , 5.346"
Stroke	40/30mm , 1.575/1.18"
Terminal Pitch	< 28mm , < 1.10"
Terminal Thickness	< 1.10 mm
Wire Section	Max 8 mm <sup>2</sup>
Feeding System	Mechanical
Weight	5.5 Kg
Dimensions	W 144 x H 145.5 x D 190 (mm) W 5.66" x H 5.72" x D 4.13" (inches)
Continuous Regulating Head	0.01mm resolution, 0.00039" 2.7mm range, 0.106"

- Can be fitted to any crimping press having a crimping height of 135.8mm (+/-) 0.02mm.
- Can be used in both manual and automatic configuration.
- Easy replacement of crimpers and anvils.

# Samruddhi Sliding Applicator

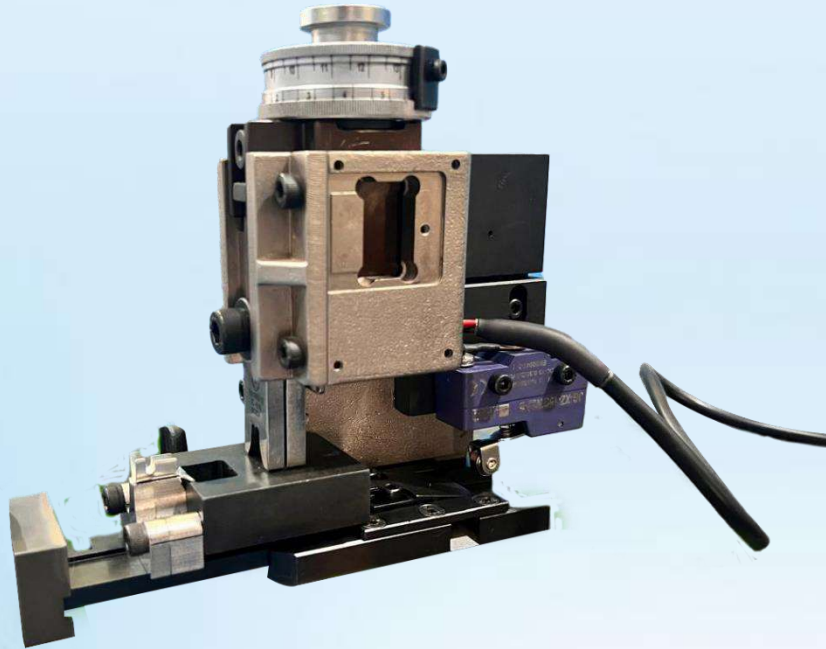

Having been conceived to handle loose terminals, the Samruddhi sliding applicator doesn't have any feeding adjustment function.

Description	Evolution End Feed Flag Terminal Mini Applicator
Crimping Height	135.8mm , 5.346"
Stroke	40/30mm , 1.575/1.18"
Terminal Pitch	Not Binding
Terminal Thickness	< 1.20 mm
Wire Section	Max 8 mm 2
Feeding System	Mechanical
Weight	5.5 Kg
Dimensions	W 144 x H 145.5 x D 190 (mm) W 5.66" x H 5.72" x D 4.13" (inches)
Continuous Regulating Head	0.01mm resolution, 0.00039" 2.7mm range, 0.106"

# Pneumatic Side Feed / End Feed Mini Applicator

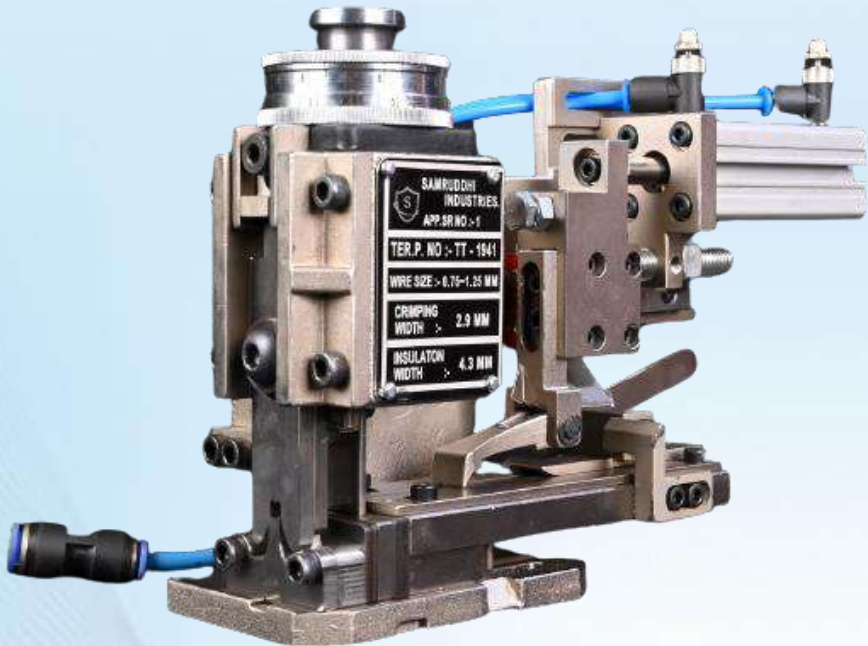

Description	Evolution Left Side Feed Mini Applicator
Crimping Height	135.8mm , 5.346"
Stroke	50/55 mm
Terminal Pitch	< 40mm
Terminal Thickness	< 1.50mm
Wire Section	Max 6 mm 2
Feeding System	Pneumatic
Weight	5.2 Kg

# Hexagon Applicator

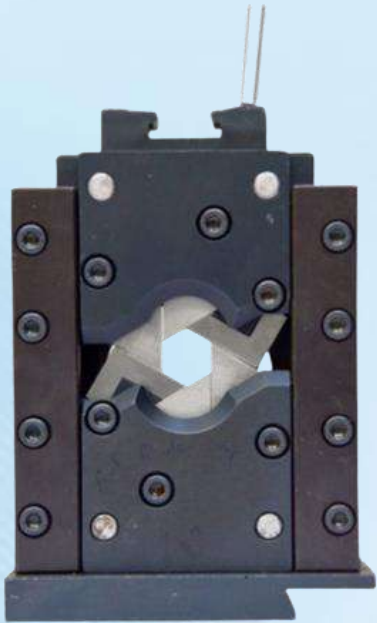

Crimping Capacity	Wire range 6 Sq mm to 70 sq mm
Features	It doesn't require to change applicator when crimping is closed tube shaped terminal from size 10-12
Terminal Pitch	< 28mm , < 1.10"
Weight	4.5 Kgs
Dimensions	500 x 450 x 480 mm

- There is no need to change molds for large and small terminals, saving time for repeated mold changes.
- Simple operation, convenient use, and high-cost performance.
- Small and beautiful appearance, convenient and fast, and high efficiency.
- Crimp accuracy  $\pm 0.03\text{mm}$ .



# Piller Loose Applicator

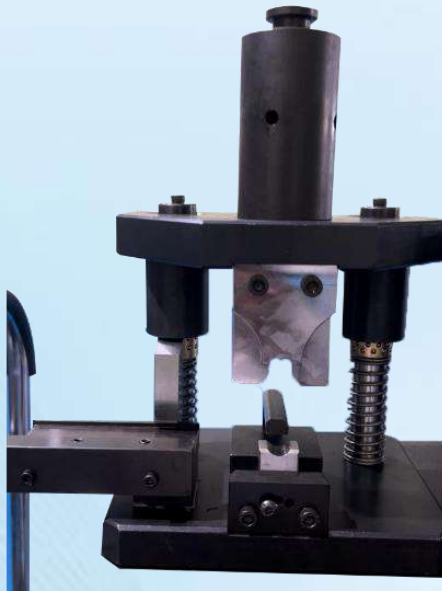

## Samruddhi Piller ( Loose Battery Terminal ) Applicator

Piller set Crimping die for big loose terminals with thickness up to **3.2 mm** and wire cross-section up to **95 sq. mm**. The terminal is loaded by means of a manually operated slide, fitted with a sensor that allows the press





**2 Ton Crimping**

## 2 Ton Crimping

Power Input	Single Phase 220 V AC 50 Hz
Motor	(Kw) 0.75
Control	Electronic
Tonnage (Ton)	2
Terminal Sheet thickness (mm)	0.7
Wire Size (Sq. mm)	6
Stroke	30/35/40 mm
Shut height Std.	135.8 mm Max: 190
Weight (Kg)	92
Dimension (L*B*H) (mm)	310*320*750

**5 Ton Crimping**

## 5 Ton Crimping

Power Input	Single Phase 220 V AC 50 Hz
Motor	1.5
Control	Electronic
Tonnage (Ton)	5
Terminal Sheet thickness (mm)	2
Wire Size (Sq. mm)	16
Stroke	30/40 mm
Shut height Std.	135.8 mm Max: 190
Weight (Kg)	130
Dimension (L*B*H) (mm)	410*420*750

## Dial



Set the top adjusting dial according to the values specify by customer in cross-section-report.

The top dial has a range of 2.2 MM with resolution of MM 0.01, every stop etched on its edge – moves the crimpers 0.01 MM Up or Down.

Since we are aiming at 0.65 We have to set the adjusting ring of the closet number to 0.65 which is 08 equivalents to an index value 6.

As we want 0.65 we have to turn the top adjusting dial five more steps (  $0.01 + 0.01 + 0.01 + 0.01 + 0.01 = 0.05$  ) to get our result (  $0.60 + 0.05 = 0.65$  ).

## Notes ( Both dials adjustment is clockwise direction )

How to adjust insulation crimping height ?

To set the correct insulation crimping height follow the same procedure described above for the wire crimping height.

If no data are available regarding the insulation crimping height set the bottom dial to ' ● ' turn it clockwise until the resulting crimping is deemed correct.

# Tooling and Spare Part



# Crimping Applicator Details

**Applicator Serial No** – 2001

**Applicator Type** – Side Feed

**Customer Name** – Dhoot Transmission CN 02

# Applicator Spare Part

**Wire Crimper** – WC 2001 – 01

**Wire Anvil** – WC 2001 – 01

**Insulation Crimper** – IC 2001 – 01

**Insulation Anvil** – IC 2001 – 01



Crimped Terminal  
**TOP View**



Crimped Terminal  
**BOTTOM View**



Crimped Terminal  
**SIDE View**

# Crimp Cross Section Analysis Details

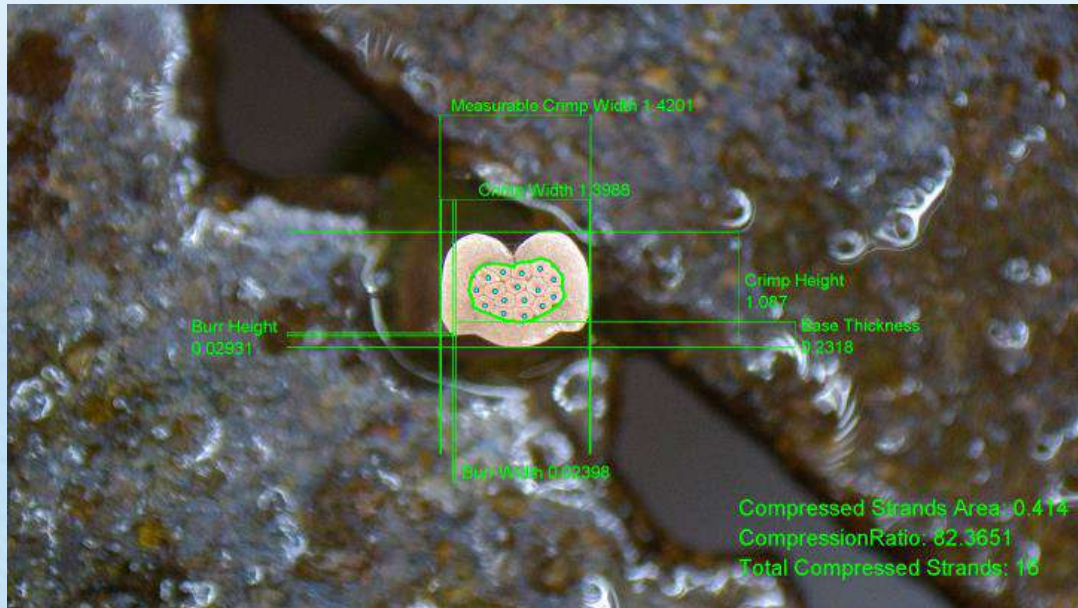

It is said that Applicators are the heart of the Crimping process, this is why quality maintenance is of critical importance. Successful Crimping results from the correct relationship between wire, terminal, & crimping tool. Once the terminal selection is made & Crimping criteria defined by the connection designer, the tooling characteristics are fully determined.

## Crimp Cross Section Analysis Details

Part No: 72141124-10	Terminal Description: 60320052KSS
Order No: 72141124-10	Pull Off Force: 9 Kg
Wire Size (Sq.mm): 0.50	Company Name: Samruddhi Industries
Wire Description: FLRY-B	Inspector Name: Mr.Vikrant Mahadik
Strand Diameter (mm): 0.2	No. Of Strands: 16
Reference wire Area (Sq.mm): 0.5027	Metal Length: 12
Terminal Manufacturer: DTPL	Reference Terminal Area: 2.52
Metal Thickness: 0.21	Inspection Date & Time: 07_Aug_2023_10_13_20

Crimp Dimension	Nominal Values & Tolerances	Measured Value	Result
Crimp Height	1.1000 (+/- 0.0500)	1.0870	GOOD
Crimp Width	1.4000 (+/- 0.1000)	1.3988	GOOD
Crimp Width (M)	1.4000 (+/- 0.1000)	1.4201	GOOD
Burr Height	Maximum (0.2100)	0.0293	GOOD
Burr Width	Maximum (0.1050)	0.0240	GOOD
Base Thickness	Minimum (0.1575)	0.2318	GOOD
Compression Ratio (%)	Range (60 - 100)	82.3651	GOOD
Strands Count	16	16	GOOD
Initial Wire Area		0.5027	
Final Wire Area		0.4140	
Crimp H/W Ratio		0.7771	
Crimp Cracks Present	YES/NO	NO	GOOD

# Our Clients



Dhoot Automotive Systems  
Pvt. Ltd.



Dhoot Electrical Systems  
Pvt. Ltd.



Dhoot  
Transmissions  
Harnessing Safety through wires

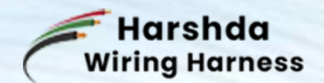



**Address** – Sr.No 24/2B, Old  
Mundhwa Road, Kharadi,  
Pune - 411014



[www.samruddhiindustries.co.in](http://www.samruddhiindustries.co.in)



[info@samruddhiindustries.co.in](mailto:info@samruddhiindustries.co.in)



**Shivaji Khanadagale** (Director)  
+91 87887 21094  
+91 96571 58884

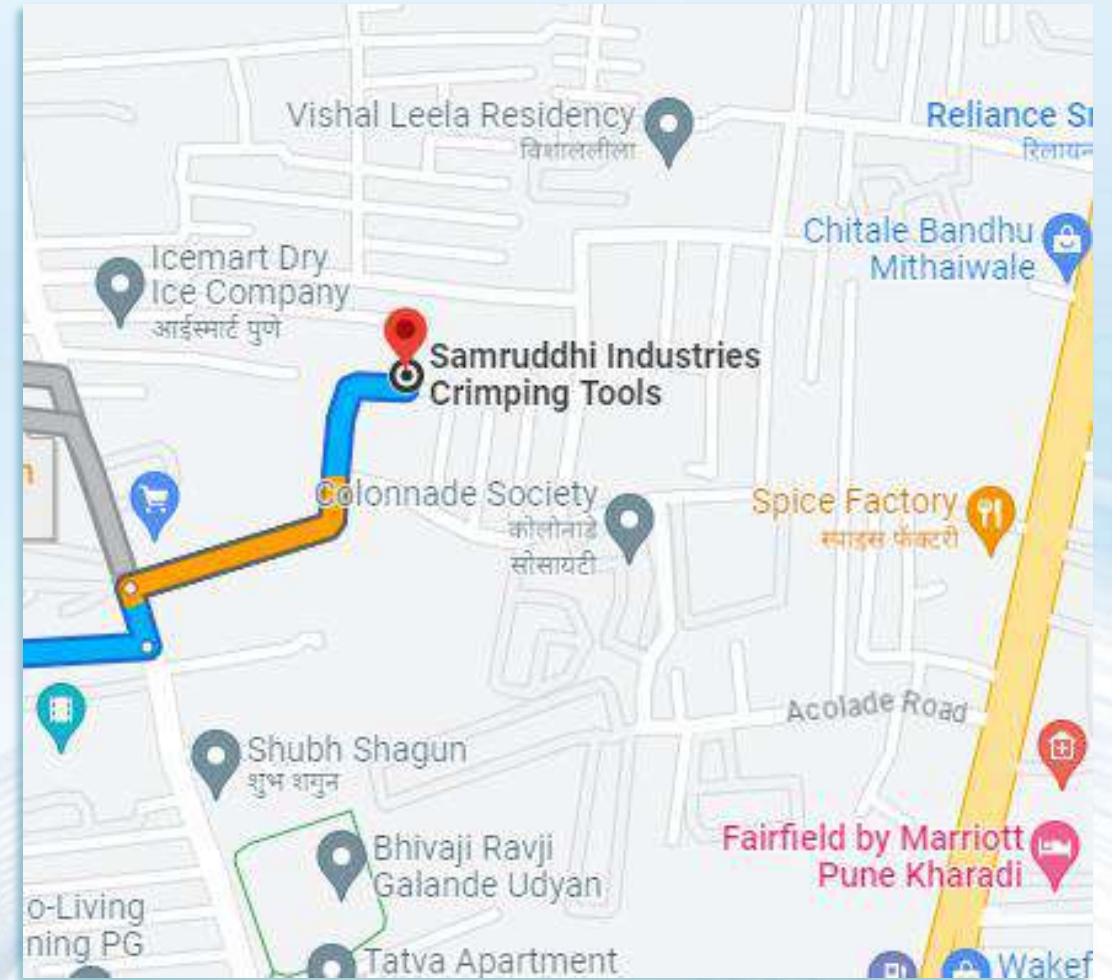

**“Integrity,  
Excellence,  
And  
Innovation In  
Every Project.”**

**Thank  
you!**